

# JAMES EDWARD

Comprehensively Cared For



## De-Barowe Mews

Leigh Road, London, N5 1ST

£1,000,000



# De-Barowe Mews



## Description

Two bedroom, two bathroom house forming part of a prestigious mews development, situated behind Highbury Barn, just a short walk to Highbury Fields and Highbury & Islington Station.

- Two Double Bedrooms
- Private Garden
- Private Gated Development
- Stone's Throw From Highbury Fields and Highbury Barn
- Two Bathrooms
- Freehold House
- Prime Highbury Location
- Short Walk to Highbury & Islington Station





# Floor Plan

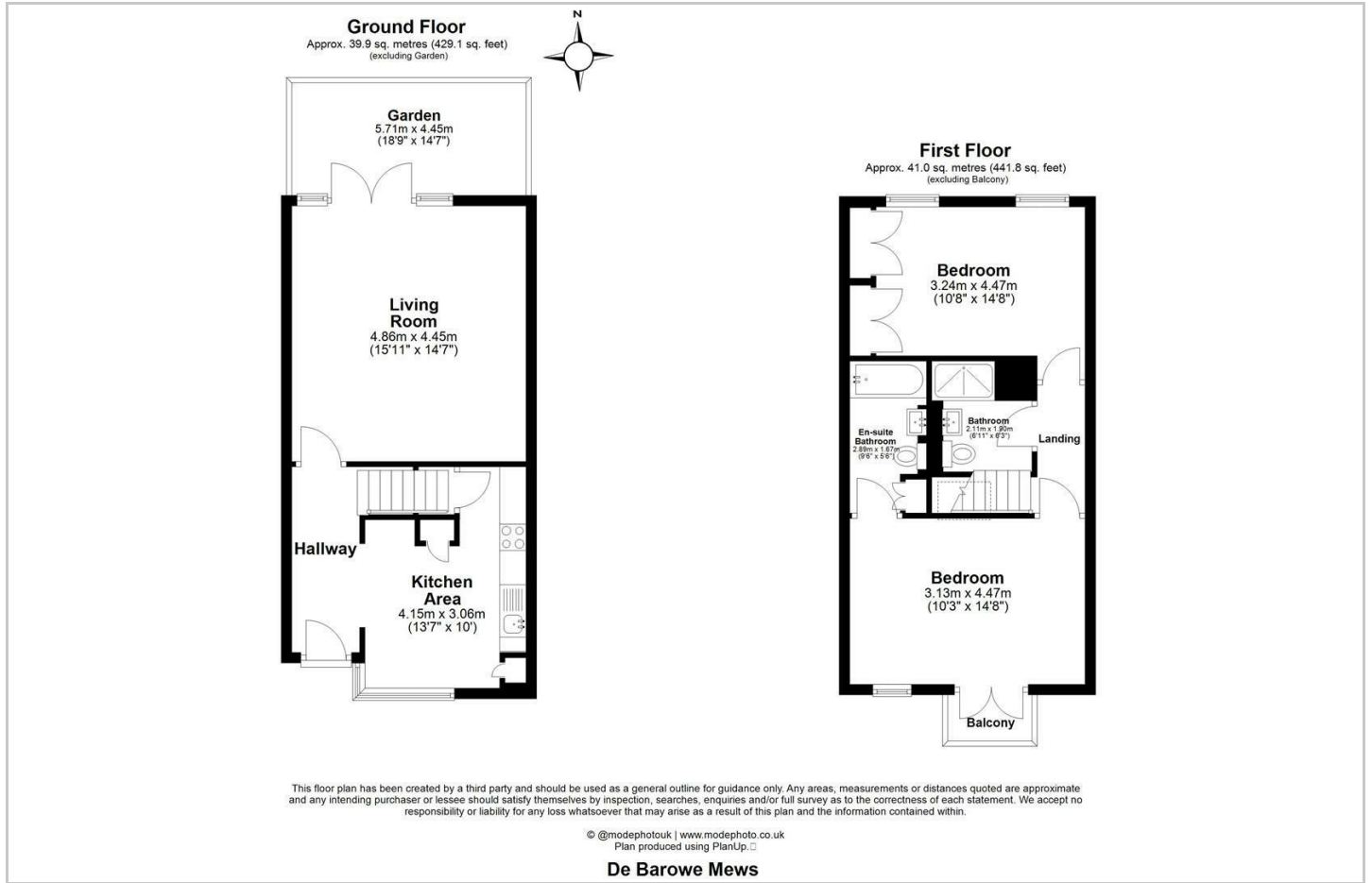

# Area Map

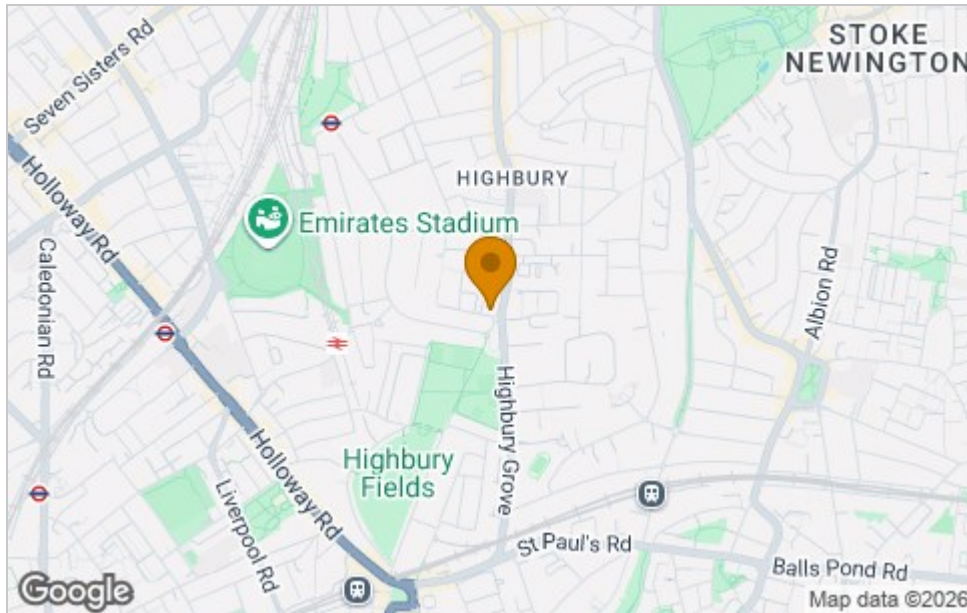

# Viewing

Please contact our James Edward Office on 020 7952 5197 if you wish to arrange a viewing appointment for this property or require further information.

These particulars, whilst believed to be accurate are set out as a general outline only for guidance and do not constitute any part of an offer or contract. Intending purchasers should not rely on them as statements of representation of fact, but must satisfy themselves by inspection or otherwise as to their accuracy. No person in this firm's employment has the authority to make or give any representation or warranty in respect of the property.

100 Highbury Park, London, N5 2XE  
Tel: 020 7952 5197 Email: info@jamesedwardproperties.co.uk <https://www.jamesedwardproperties.co.uk>

# Energy Efficiency Graph

